

14 Diagrams & Parts List

Lathe Bed

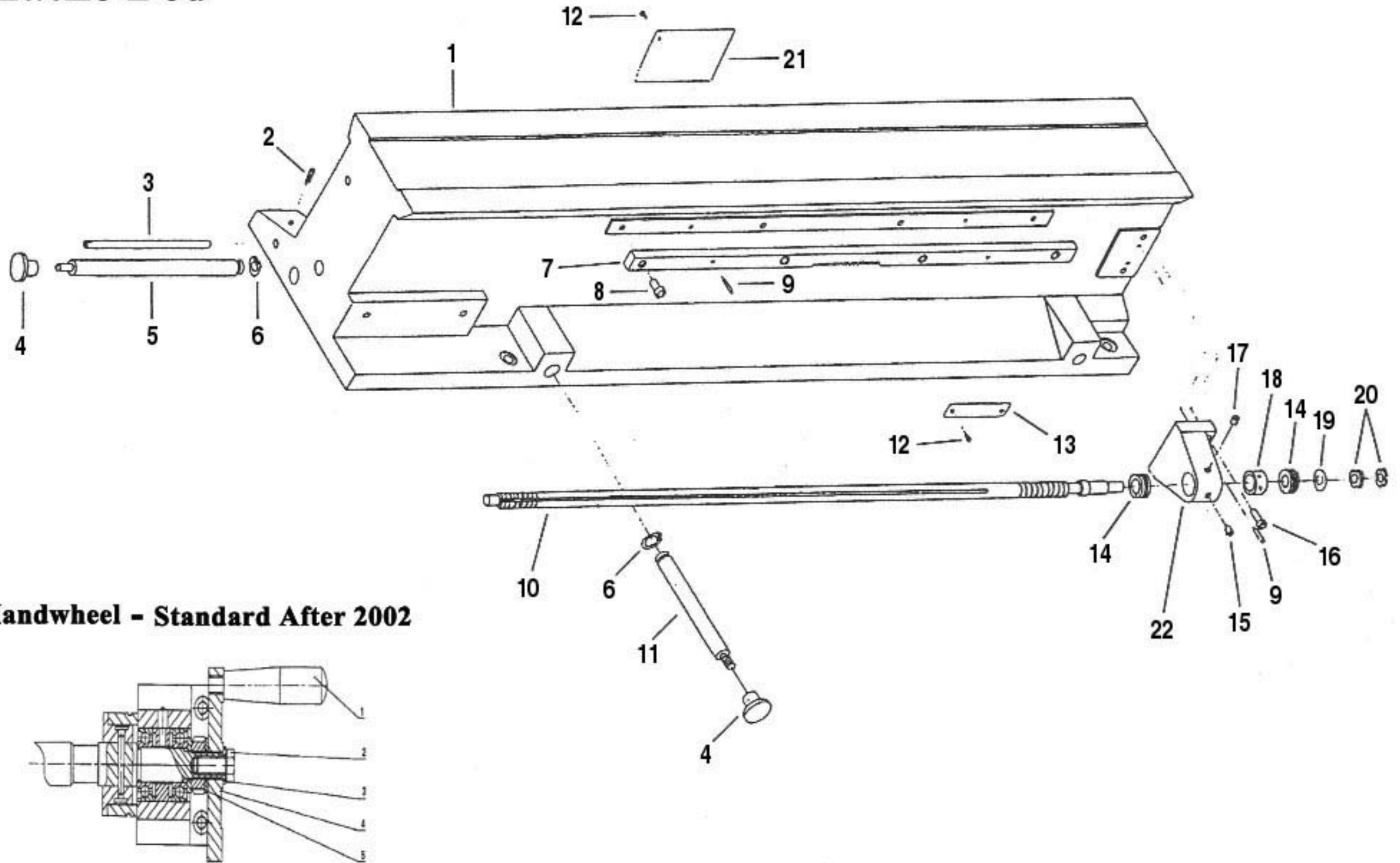

Handwheel - Standard After 2002

Lathe Bed & Handwheel

Diagram Number	Part Number	Reference Number	Description
1	G01001 G01001L	1-01	Bed for GN-1324 Bed for GN-1340
2	G01002	S11992	Cone-point set screw M6 x 20
3	G01003	1-02	Shaft Pin
4	G01004	C30030	Lifting Knob
5	G01005	1-22	Lifting Pin (II)
6	G01006	GB894.1	Snap Ring M20
7	G01007	Rack for	GN-1324
	G01007L	1-12	Rack for GN-1340 (Note: This is two pieces)
8	G01008	S11340	Sockethead Cap Screw M6 x20
9	G01009	GB117	Taper Pin M4 x 22
10	G01010		Leadscrew for GN-1324
	G01010L	1-13	Leadscrew for GN-1340
11	G01011	C30063	Lifting Pin
12	G01012	BG827	Rivet M2 x 5
13	G01013	1-24	Smithy Plate
14	G01014	GB292	Angular Contract Bearing 46102
15	G01015	GB71	Setscrew M6 x 10
16	G01016	GB70	Hex-Socket Screw M6 x 20
17	G01017	C30050	Oiler #6

Diagram Number	Part Number	Reference Number	Description
18	G01018	1-15	Spacer
19	G01019	GB97.1	Washer M12
20	G01020	GB812	Spanner Nut M12 X 1.25
21	G01021	1-25	Data Plate
22	G01022	1-14	Leadscrew Support

Additional Leadscrew Dial Assembly G91023

1	G01023		Leadscrew Outer Dial
2	G05068		Leadscrew Inner Dial
3	G05069		Dial Spring
4	S11946		Dial Setscrew
5	G91023		Leadscrew Assembly

Handwheel Assembly

1	G01028	HY8310.4-1	Handle
2	SS160		Bolt, 5/16"-18 x 1/2"
3	S18140	GB97.1-85	Washer, M8
4	G01027	G1324.1-29	Hand Wheel
5	S18200	GB97.1-85	Washer, M12